

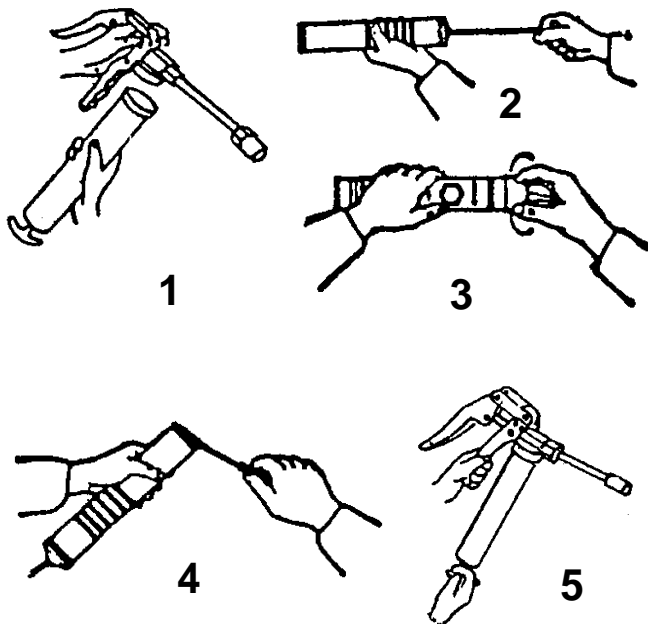

# HAND GREASE GUN

## OPERATING INSTRUCTIONS



### GREASE CARTRIDGE LOADING

1. Remove the gun head from the container tube.
2. Draw back the plunger handle entirely.
3. Insert open end of cartridge into container tube and push all the way in. Remove the seal or pull tab end from the cartridge.
4. Reassemble the gun head to the container tube. Press the catch plate and release the piston rod. Pull down the plunger handle.
5. Draw back plunger rod fully and release quickly. Repeat 2 or 3 times. This will help exert force to move the rubber ring to enter the cartridge, which is the essential for a grease gun to work. Push plunger rod all the way in. Tighten the gun head to the container tube.

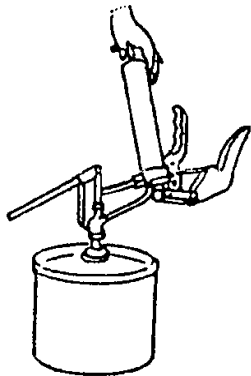

### DISPENSER LOADING

- STEP 1) Remove slotted plug from head assembly and insert the proper loader fitting that adapts to pump being used.
- STEP 2) Extend level out on the grease gun and insert the loader fitting into pump adapter and fill.
- NOTE: Always remove used cartridge from gun when bulk filling.

### BULK LOADING

#### A. FILL WITH SCOOP OR WOODEN PIECE

- STEP 1) Remove the gun head from the container tube.
- STEP 2) Draw back the plunger handle entirely. Fill loose grease into empty container tube.
- STEP 3) Reassemble the gun head to the container tube. Release the piston rod. Push down the plunger handle.

#### B. SUCTION FILLING

- STEP 1) Remove the gun head from the container tube.
- STEP 2) Submerge open end of the container tube into grease bucket about 2" deep and pull the plunger handle out slowly and engage rod into slot. Reassemble
- STEP 3) the gun head to the container tube. Release the piston rod. Push down the plunger handle.

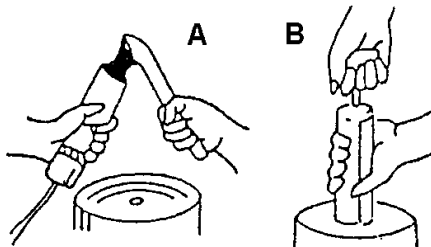

#### IMPORTANT:

\* If gun loses its prime, it is due to air pockets in the lubricant.

#### TO REPRIME:

\* Unscrew container tube to 1-1/2 turns. Withdraw rod and rotate to engage follower. Push rod into container tube to expell the air pockets. Tighten gun head to container tube, disengage rod from follower and push rod into it.

\* Now your grease gun is ready for use.

## HIGH PRESSURE AND HIGH VOLUME MODE CHANGE

### From High Volume mode to High Pressure mode

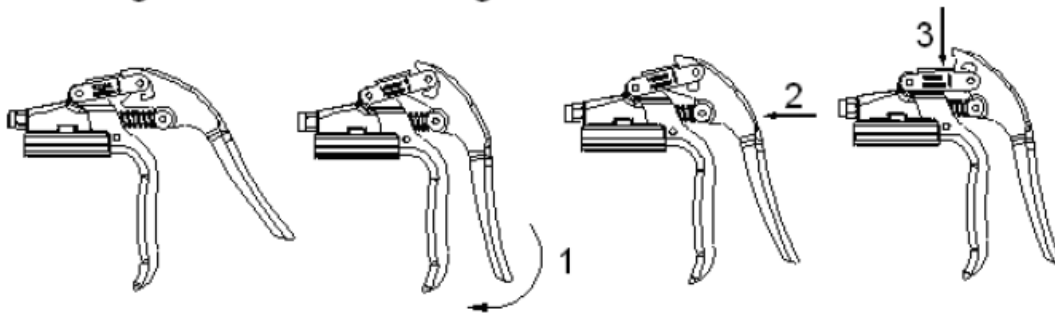

Step 1: push the handle to the position as the arrow 1.

Step 2: hold the handle as step 1, and then push the upper point of the handle as the arrow 2 showed.

Step 3: keep the position of step 1 & 2 and push down the lever as the arrow 3 to change to high pressure mode.

### From High Pressure mode to High Volume mode

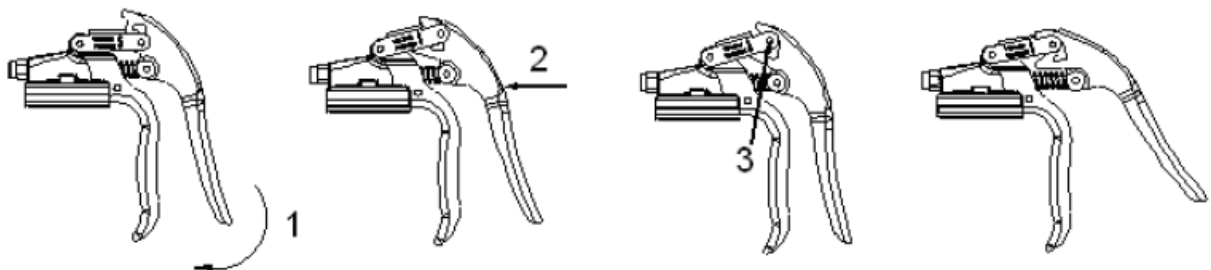

Step 1: push the handle to the position as the arrow 1.

Step 2: hold the handle as step 1, and then push the upper point of the handle as the arrow 2 showed.

Step 3: keep the position of step 1 & 2 and push up the lever as the arrow 3 to change to high volume mode.