

# UREA/DEF 240V Barrel Pump Kit UDDP20K

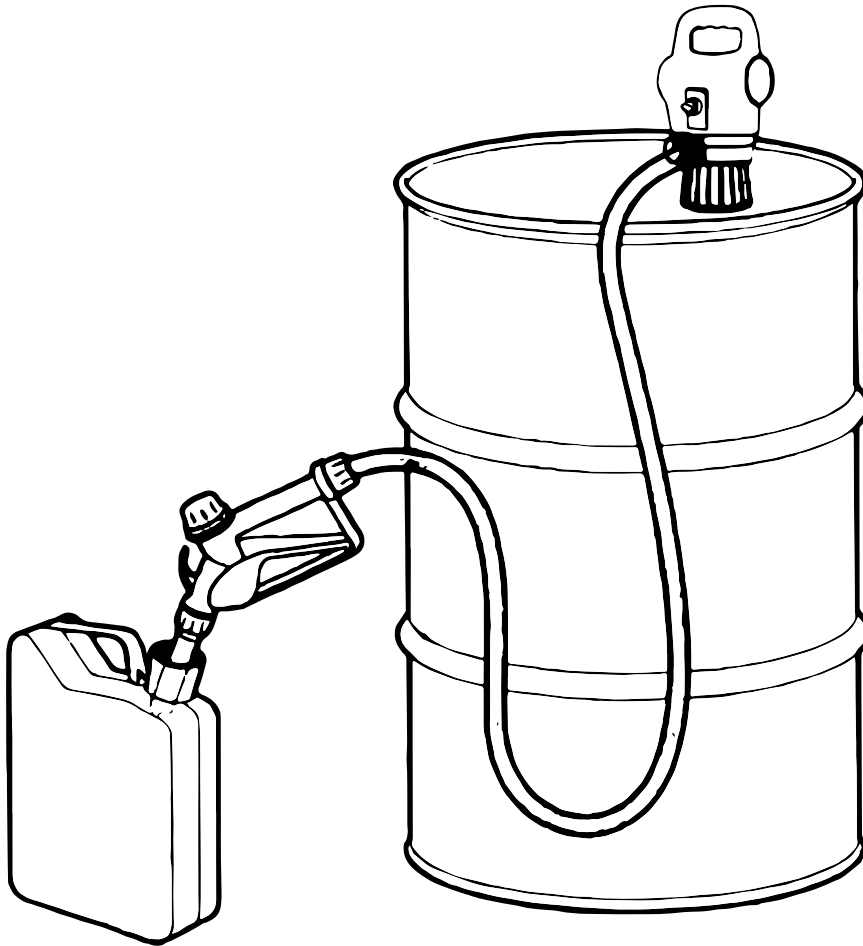

- Wetted component: Viton, Stainless steel PE, PP
- Used for UREA/DEF, antifreeze, detergents, pesticides, herbicides, urea and weak acid/base chemicals
- Motor: 12 V, 30 W
- Duty cycle: 15 minutes/15 minutes off
- With 12 V DC battery cable and AC to DC adaptor
- Flow rate: 19 LPM/5GPM
- Telescopic suction tube length: 850 mm to 1245 mm
- Built-in 2" BSP male thread for 1000 litre IBC tank
- With 2" BSP female to mauser 70x6 mm adaptor for 205 litre drum
- With 2" BSP female to mauser 56x4 mm adaptor for 205 litre drum
- With 2 m deliver PVC hose and manual dispensing nozzle

Electric drum pump designed for pumping fuels, water base media, light oil, ADBLUE DEF and selected chemicals from metal drums of 55 gallon (205 litre or 275 gallon) 1000 litre IBC's.

Compact and lightweight construction

Convenient ON/OFF switch with LED indicator.

Built-in fuse for overload protection

Silenced motor makes almost no noise

Stainless steel filter built into the suction tube inlet prevents contaminants from getting in and causing damage.

Built-in 2" bung adaptor fits directly onto metal drums of 55 gallon (205 litre). Bung adaptor can be adjusted by 0.6" (15mm) to adjust to drums with varying heights.

Includes and additional bung thread converter for converting 2" standard bung threads to 2.5"x 5mm buttress for using pump with IBC's.

Telescopic suction tube extends from 33-1/2" (850mm) to 49" (1245mm) for use with 55 gallon (205 litre) drums or 275 gallon (1000 litre) IBC's

Supplied complete with 3m (10 ft) hose and manual dispensing nozzle with 3/4" (19mm) OD stainless steel spout.

Duty cycle: 15 minutes on / 15 minutes off

**WETTED COMPONENTS**

Viton, POM, stainless steel, PE, NBR, PP

**RECOMMENDED USE**

Diesel, Kerosene, bio diesel, DEF ADBLUE, water base media, antifreeze, detergents, pesticides, herbicides, urea, lights oil with viscosity up to 100cst.

**DO NOT USE**

Gasoline, corrosive chemicals, lacquer thinners, any material that is not compatible with the pump construction.

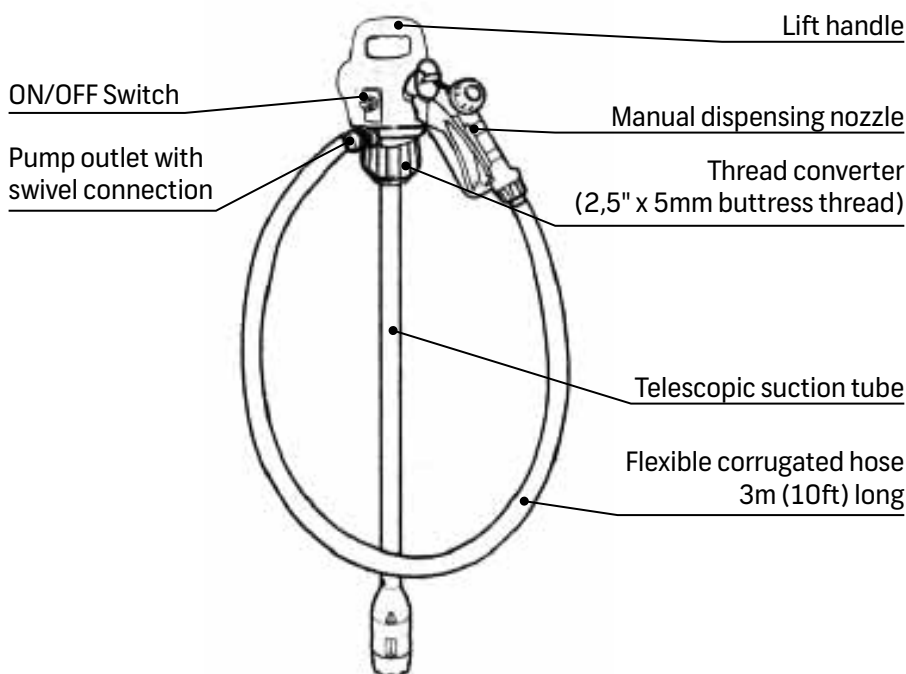

**12V 3200MAH BATTERY**



Delivers: UP TO 28 L/M (7.4 G/M)

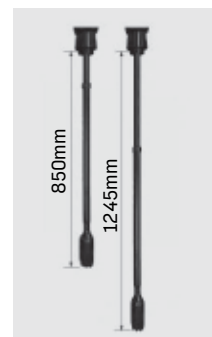

1. Rotate the joint nut anticlockwise and then pull the strainer end of the suction tube away from the bung.
2. After extending the suction tube rotate the joint nut clockwise to fix the suction tube in the extended position.

**SPECIFICATION**

Motor type	DC Brush Motor (5 pole)
Temperature	5° a 40°C
Max. viscosity of media	100 cst

**POWER SOURCE**

Power source	Rechargeable (Li-ion)
Power cord	Rechargeable 3.2 Ah Li Ion with 1h hour quick charger
Voltage	12V battery & AC charger (100V - 240V)
Max. discharge	28 LPM (7.4GPM)

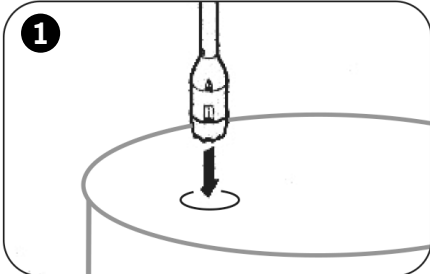

1 Insert the pump into the drum through the drum hole

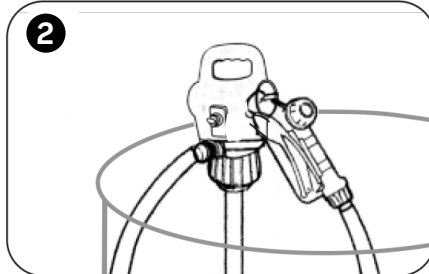

2 Screw the bung adaptor with the drum hole.

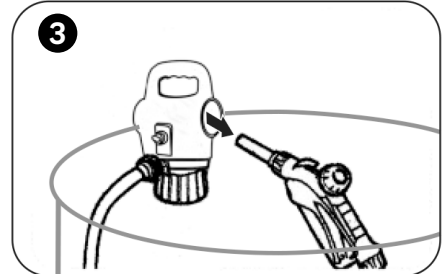

3 Place the nozzle inside the nozzle holster provided on the side of the pump.

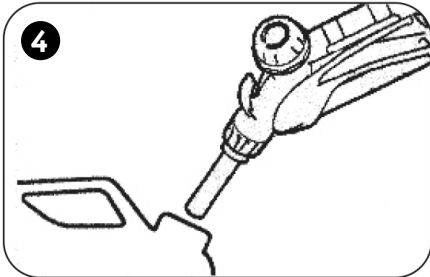

4 Place the nozzle into the receiving container to transfer the liquid.

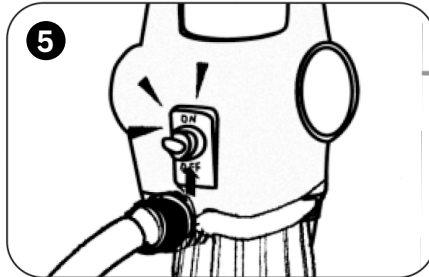

5 Switch ON the toggle switch (up) and pull the nozzle trigger.

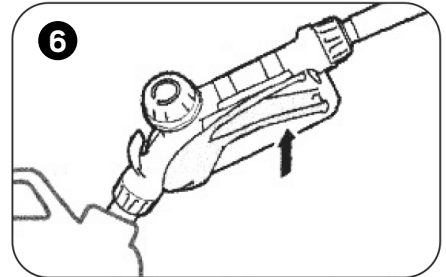

6 Turn on the trigger.

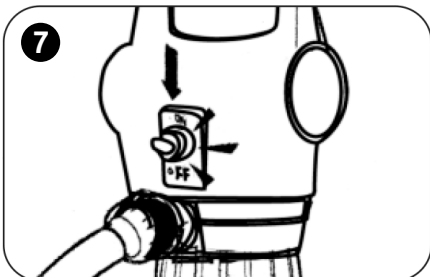

7 Switch off when finished the transfer fluid.

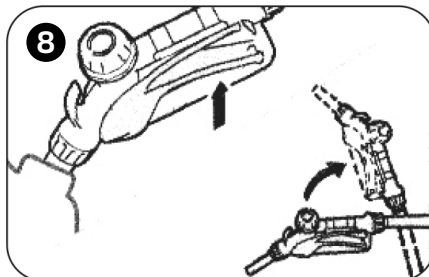

8 Take off the nozzle from drum.

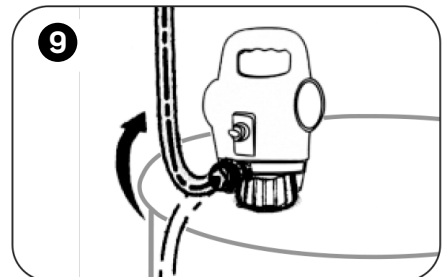

9 After dispensing switch off the toggle switch (down) and lift the nozzle upward allowing all the liquid in the line to flow back into the drum.

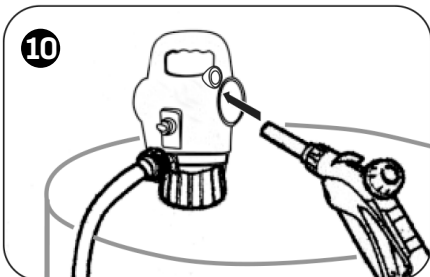

10 Place the nozzle back into the holster to prevent any damage to the hose or to the nozzle.

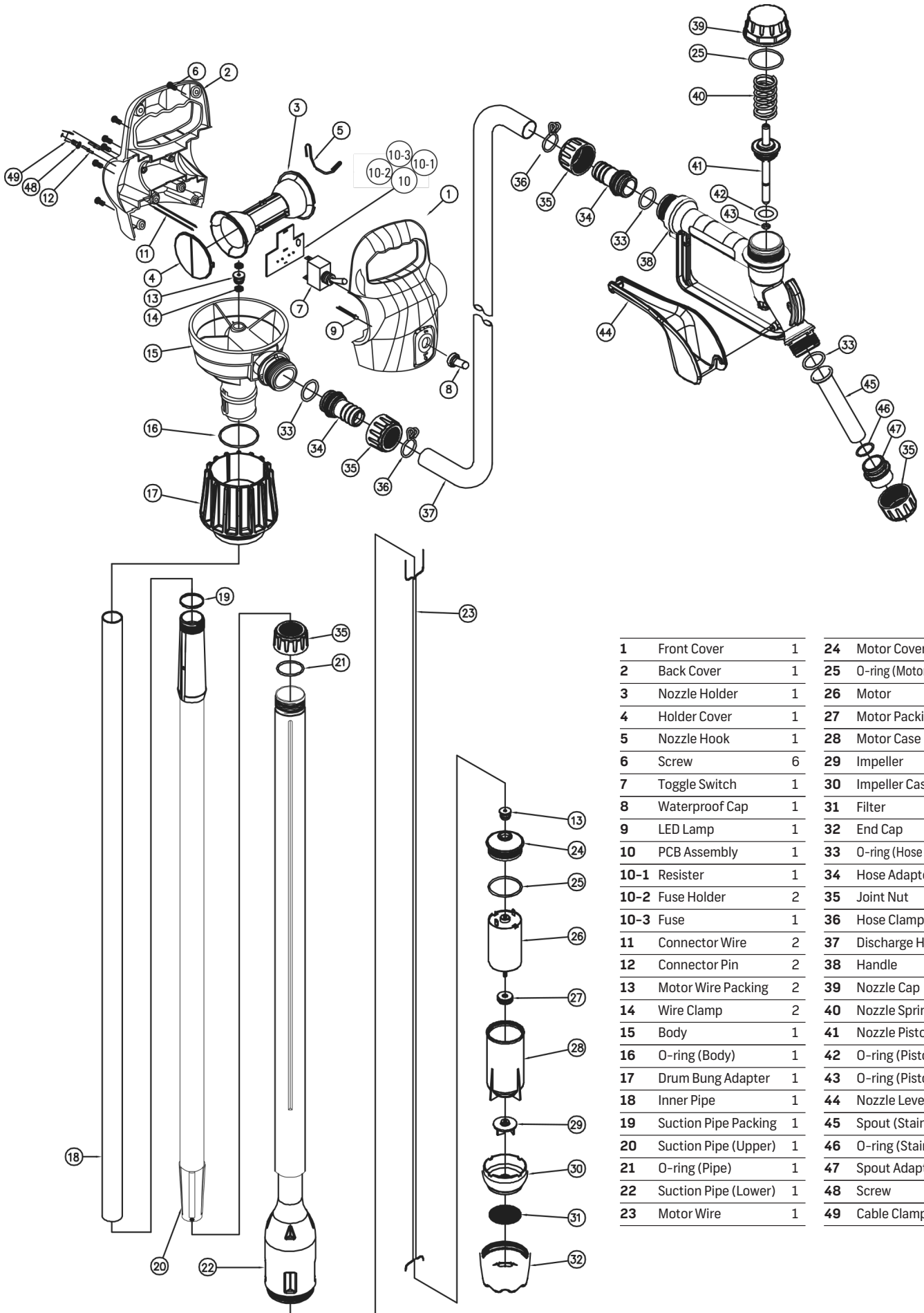

1	Front Cover	1	24	Motor Cover	1
2	Back Cover	1	25	O-ring (Motor Cover, Handle)	2
3	Nozzle Holder	1	26	Motor	1
4	Holder Cover	1	27	Motor Packing	1
5	Nozzle Hook	1	28	Motor Case	1
6	Screw	6	29	Impeller	1
7	Toggle Switch	1	30	Impeller Casing	1
8	Waterproof Cap	1	31	Filter	1
9	LED Lamp	1	32	End Cap	1
10	PCB Assembly	1	33	O-ring (Hose Adapter, Spout)	3
10-1	Resistor	1	34	Hose Adapter	1
10-2	Fuse Holder	2	35	Joint Nut	3
10-3	Fuse	1	36	Hose Clamp	2
11	Connector Wire	2	37	Discharge Hose	1
12	Connector Pin	2	38	Handle	1
13	Motor Wire Packing	2	39	Nozzle Cap	1
14	Wire Clamp	2	40	Nozzle Spring	1
15	Body	1	41	Nozzle Piston	1
16	O-ring (Body)	1	42	O-ring (Piston L)	1
17	Drum Bung Adapter	1	43	O-ring (Piston S)	1
18	Inner Pipe	1	44	Nozzle Lever	1
19	Suction Pipe Packing	1	45	Spout (Stainless Steel)	1
20	Suction Pipe (Upper)	1	46	O-ring (Stainless Nozzle)	1
21	O-ring (Pipe)	1	47	Spout Adapter	1
22	Suction Pipe (Lower)	1	48	Screw	1
23	Motor Wire	1	49	Cable Clamp	1